



MEDIA RELEASE

Implenia wins building construction contracts in Germany and Switzerland worth a total of over CHF 170 million

Commission as total contractor to plan and build a rehearsal and workshop centre for the Bavarian State Theatre in Munich | Partnership-based project execution with integrated range of services | Two new replacement apartment buildings | Focus on sustainability | Contracts worth over CHF 170 million in total

Glattpark (Opfikon), 30 May 2023 – The Bavarian Ministry of Science, Research and Art has commissioned Implenia as total contractor to plan and build a new rehearsal and workshop centre for the Bavarian State Theatre (Bayerisches Staatsschauspiel) in Munich. After the reception facility in Regensburg and the Regensburg state housing development, this is already the third project that Implenia is realising as a total contractor for the Free State of Bavaria as the client, represented by the Regensburg State Building Authority. Planning began in March, and construction starts in June. The completed building should be handed over to the client in December 2026. The order is worth more than EUR 140 million to Implenia.

Contracted services include planning and construction of the new 93-meter-long, 86-meter-wide L-shaped building – from the construction pit to the interior fit-out including building technology, conveyor technology and stage technology for three rehearsal stages, to the workshop and canteen equipment. The contract also encompasses the design of outdoor facilities, including a work-yard with access zones, delivery and parking areas for trucks and containers, an underground car park and green landscaping.

This technically demanding project involves the creation of large clear-span spaces for the rehearsal stages using a steel composite construction familiar from bridge construction. A highly effective structural separation joint protects the rehearsal areas from noise and vibrations emanating from the workshops. Other special sound insulation features ensure that the different rehearsal stages can be used simultaneously without disturbance. Implenia has brought in top planners for the specialist technical aspects of stage and workshop construction.

Emphasis on partnership and integration convinced during tender phase

Implenia convinced the client during the tender process with its partnership-based approach and the way its team of highly qualified internal and external specialists offered solutions to the project's complex technical challenges. During the implementation phase Implenia will manage the team and, together with its own specialist planners, take care of approval and execution planning as well as turnkey construction of the new building.

Implenia, as an integrated construction and real estate services provider, will provide many of the services from its own Divisions. The company's Special Foundations unit is responsible for the construction pit. Its Civil Engineering specialists will be brought in to help with the core and shell build. BCL Building Construction Logistics, part of the Implenia Group, will ensure that the construction site is properly organised for smooth, safe and sustainable operation. Experts from the company's Facade Technology unit will help construct the building envelope, which features dark grey corrugated fibreboards, precast concrete elements and aluminium window elements with external blinds.

Digitalisation and tools to increase efficiency

All the planners involved in the new building are working with a specially created BIM model, which ensures that the latest planning status is clear to everyone and can be updated flexibly. The BIM model is also being used during the execution phase – to coordinate the various trades, for example. The model will also be used for construction process simulations, quantity take-off, and tendering for finishing works.

Lean construction methods and tools are being used to optimise construction processes, control material flows and ensure precise coordination of trades. This will enable a continuous and consistent construction process.

High sustainability standards

Implenia and its client both attach importance to the sustainability of the new building's construction and operation. The building is being built in accordance with Germany's Building Energy Act (GEG § 10), all materials comply with the "Low-pollutant construction" criteria (QN 3) set out by the Bavarian State Building Directorate, and the technical systems are designed for sustainable and environmentally friendly operation.

Besenrain- and Katzenbachstrasse Zurich – sustainable new residential buildings

In Switzerland, Implenia has been commissioned as total contractor by its client Swiss Life Asset Management AG to replace a building at Besenrain-/Morgentalstrasse in Zurich Wollishofen. The project will create a new solid-wall building with 36 rental apartments and 22 underground parking spaces. Construction work started in March with the removal of hazardous substances. Handover is planned for the end of November 2024. SNBS Platinum certification is being sought for the new building.

Implenia has also been awarded a contract by the SBB Pension Fund to replace a building on Katzenbachstrasse in Zurich-Seebach. Implenia will also carry out this project as total contractor. This new building will include 30 high-quality rental apartments with ventilated wooden facades across three storeys, and 18 underground parking spaces. Construction work started in February with a clean-up of hazardous substances by Implenia's Master Builder unit. Completion is planned for February 2025. The apartments are being built to the Minergie ECO standard.

Through these two contracts, Implenia is continuing to lend its extensive expertise to the sustainable renewal of Switzerland's real estate portfolio. The two contracts are worth over CHF 30 million in total.



A demanding and complex new build for the Bavarian State Theatre in Munich: new rehearsal and workshop centre in the east of Munich (image: © Dömges Architekten AG, Regensburg).

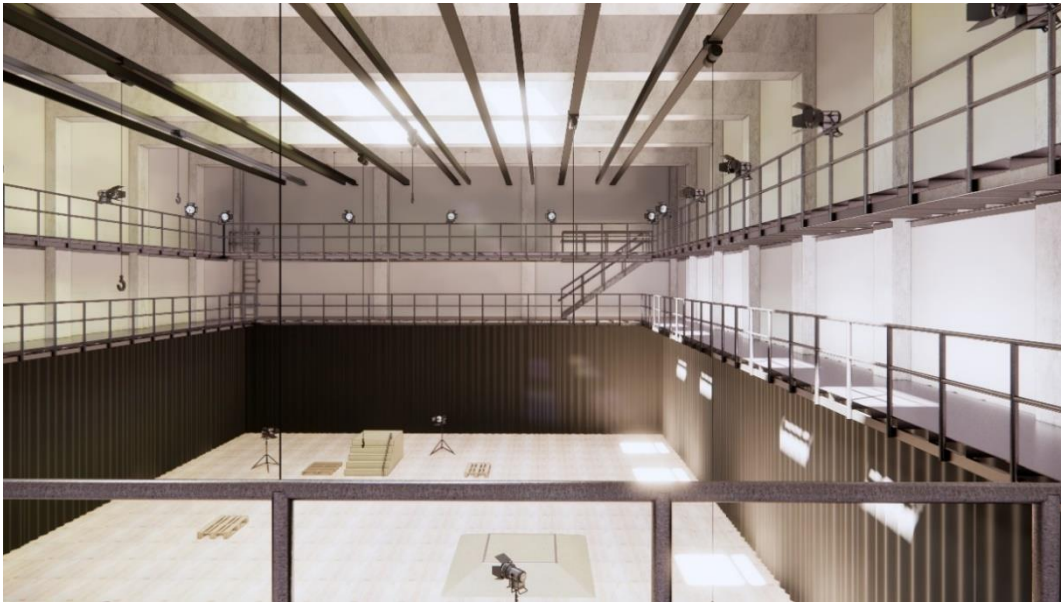

Three rehearsal stages and new workshops for the Bavarian State Theatre will be ready for operation at the end of 2026 (image: © Dömges Architekten AG, Regensburg).



The new Katzenbach residential development of 30 apartments in Zurich-Seebach (image: © Think Architecture AG).

Contact for media:

Corporate Communications, T +41 58 474 74 77, communication@implenia.com

Contact for Investors and Analysts:

Investor Relations, T +41 58 474 35 04, ir@implenia.com

Dates for investors:

16 August 2023: Interim results 2023, Analysts and Media Conference

As Switzerland's leading construction and real estate service provider, Implenia develops and builds homes, workplaces and infrastructure for future generations in Switzerland and Germany. It also offers tunnelling and related infrastructure projects in further markets. Formed in 2006, the company can look back on around 150 years of construction tradition. Implenia brings together the know-how of its highly skilled development, planning and execution units under the umbrella of an integrated leading multinational construction and real estate service provider. With its broad offering and the expertise of its specialists, the Group realises large, complex projects and provides client-centric support across the entire life cycle of a building or structure. It focuses on client needs and on striking a sustainable balance between commercial success and social and environmental responsibility. Implenia, with its headquarters in Opfikon near Zurich, employs more than 7,600 people across Europe and posted revenue of CHF 3.6 billion in 2022. The company is listed on the SIX Swiss Exchange (IMPN, CH0023868554). More information can be found at [implenia.com](https://www.implenia.com).