

Zug lido

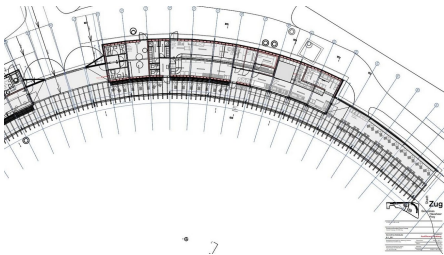

SHORT DESCRIPTION

New construction and extension of the Zug lido - an arched timber building with a filigree lake façade, pergola, brise-soleil elements and precisely fitted exterior doors. Realized with Swiss wood and cellulose insulation.

THE PROJECT

For the new construction and extension of the Zug lido, we were able to realize an architecturally special, arched timber construction - including exterior doors, gates and folding shutters. The lakeside façade is a particular highlight: it was designed as a filigree slatted screen and harmoniously combined with the pergola, the shade grid, the integrated bench and the surrounding brise-soleil elements. The exterior doors were precisely matched to the different façade types and blend almost invisibly into the overall picture.

SERVICES IN DETAIL

Element construction in wood incl. facade Exterior doors in wood incl. gates Folding shutters

CHALLENGES

The arched construction with its numerous different façade types and many sophisticated details placed high demands on the factory planning, production and assembly. However, thanks to precise coordination, well thought-out implementation and the specialist knowledge of our timber construction experts, these challenges were successfully mastered to the highest standard.

SUSTAINABILITY

The building materials used come from sustainable production. Only Swiss wood was used for the façade, while cellulose fibers were used for the insulation. The project is thus emblematic of an all-round sustainable construction method and the conscious use of ecological materials.

FACTS

Location	6300 Zug , Switzerland
Status	completed
Construction volume (value of our services)	1.1 M CHF
Start of construction	June 2025
Completion	April 2026
Building owner	Stadt Zug
Architect	Gonçaves Hausheer Frey GmbH
Construction management	4 build architecture AG
Construction management	4 build architecture AG
Civil engineer	Makiol Wiederkehr AG

SERVICES

Timber construction

Modular construction



<https://implenia.com/en/references/detail/ref/zug-lido/>

Creation: 11.05.2026 19:44