

LOOP - Residential complex Radrennbahn

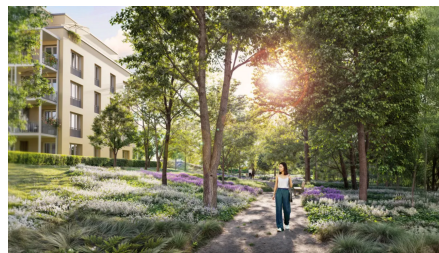

SHORT DESCRIPTION

Implenia is building timber-hybrid housing, a daycare center and local shops on the site of the former cycling track.

THE PROJECT

Implenia Hochbau has been awarded the contract for the turnkey construction of a new residential complex with 76 residential units, a daycare center and commercial space. The project is a sub-project (construction phase 1) of the district development in three construction phases on the site of the former cycling track in Nuremberg-Reichelsdorf.

SERVICES IN DETAIL

The three apartment buildings are connected via an adjacent underground parking garage in the basement and are accessible from here. Buildings 1+2 will be constructed with cellar compartments and technical rooms in the basement, a four-group daycare facility on the ground floor and 32 publicly subsidized rental apartments on the four upper floors.

Building 3 will be constructed with cellar compartments and technical rooms in the basement, a commercial space on the

first floor for up to four commercial units and 44 publicly subsidized rental apartments on the four upper floors.

CHALLENGES

Construction of the building project in a very short shell construction time with an early opening date for the KITA in building 1+2.

SUSTAINABILITY

The project is being built as an "Efficiency House 40 NH" in accordance with the KfW standard and the DGNB certificate in gold is being sought. The buildings will be constructed as timber-hybrid structures from the 1st floor upwards. House 3 will have a timber façade with vertical or horizontal timber cladding, ventilated, on a timber substructure.

FURTHER INFORMATION

[Projektwebsite](#)

Pictures: © Immosense

FACTS

Location	Vorjurastr. 176, Nürnberg , Germany
Status	Under construction
Construction volume (value of our services)	18.48 M EUR
Start of construction	March 2026
Completion	October 2027
Usage	Wohnen, Kita, Gewerbe
Building owner	immosens ECKPFEILER Reichelsdorf GmbH & Co. KG, Nürnberg
Architect	Maier Neuberger Architekten GmbH, München
Build volume	12850 m ²
Number of upper floors	4
Number of basement floors	1
Number of flats	76
Number of parking spaces	57

SERVICES

Hochbau (Deutschland)

Schlüsselfertiges Bauen



<https://implenia.com/en/references/detail/ref/upcycle-wohnanlage-radrennbahn/>

Creation: 16.04.2026 22:25