

## Reileck / Gravo-Druck

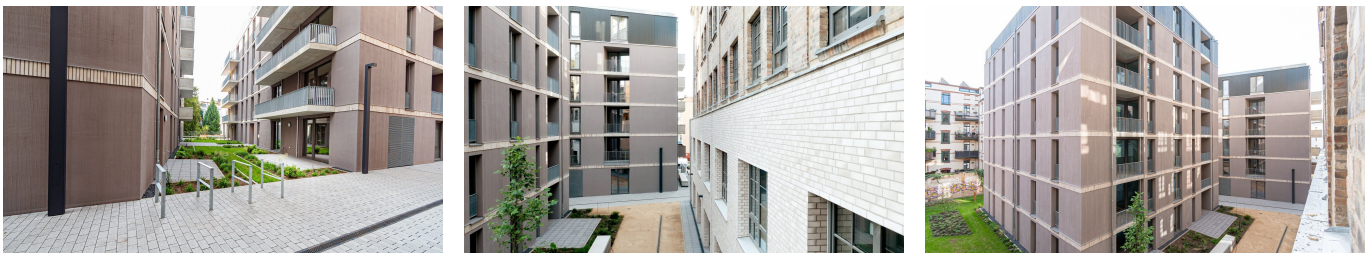

### SHORT DESCRIPTION

Implenia is working in a consortium to build a residential complex with a commercial component by converting and constructing a new building on the site of a former printing plant.

### THE PROJECT

The residential complex with a commercial component is being built by converting the former GravoDruck administration building and constructing new buildings to close the gap in the perimeter block development at Reileck in the Paulusviertel district of Halle (Saale).

### SERVICES IN DETAIL

The plan is to build five new residential buildings and to convert and refurbish the listed former printing plant building. A total of 134 apartments, three office units, two medical practices, a further commercial unit, an organic food market with café and outdoor seating area, an underground car park and the outdoor facilities with bicycle parking and refuse storage will be built.

The contract includes demolition, conversion of the striking brick building of the former GravoDruck, implementation planning (Lph5 according to HOAI) and turnkey construction of the new building. Implenia is implementing the project as technical management in a consortium.

## SUSTAINABILITY

The buildings will be constructed to the KfW55 standard.

## FURTHER INFORMATION

(c) Snarq Architects, Halle

## FACTS

<b>Location</b>	Reilstr. 133, Halle , Germany
<b>Status</b>	completed
<b>Construction volume (value of our services)</b>	17.133 M EUR
<b>Start of construction</b>	June 2022
<b>Completion</b>	December 2024
<b>Building owner</b>	Reileck Projekt GmbH, Halle (Projektgesellschaft der Saalesparkasse)
<b>Architect</b>	Snarq Architekten BDA, Halle
<b>Living area</b>	13200 m <sup>2</sup>
<b>Number of upper floors</b>	6
<b>Number of basement floors</b>	1
<b>Number of flats</b>	134

## SERVICES

---

Sanieren, Umbauen und Revitalisieren

Beraten und Planen

Schlüsselfertiges Bauen

Real Estate

Hochbau (Deutschland)



---

<https://implenia.com/en/references/detail/ref/reileck-gravo-druck/>

Creation: 21.04.2026 01:24